

# Control unit Ecoline-E / -Remote

for DC motor with encoder serie Ecoline-E

OEM

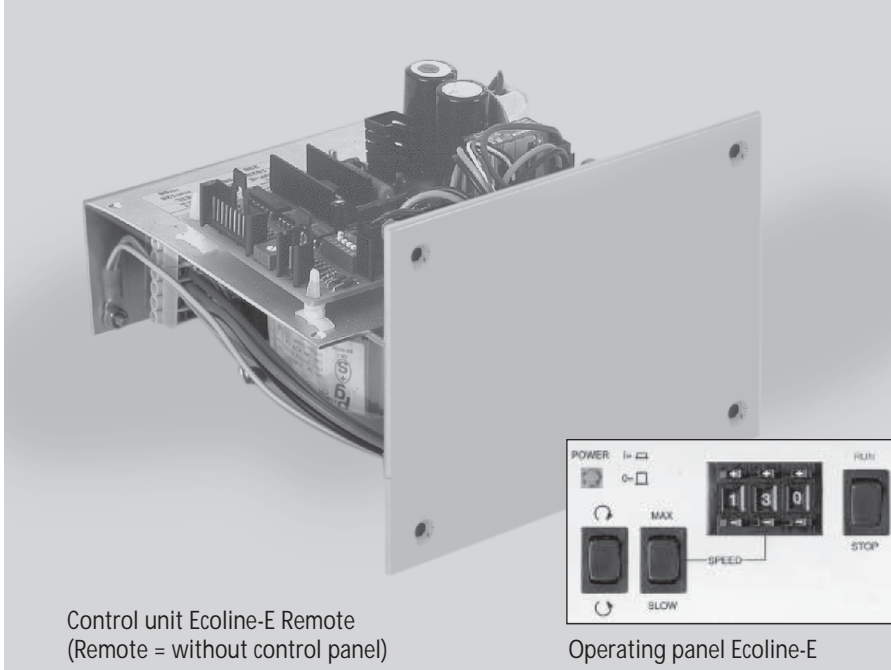

Control unit Ecoline-E Remote  
(Remote = without control panel)

Operating panel Ecoline-E

Side view (mm)

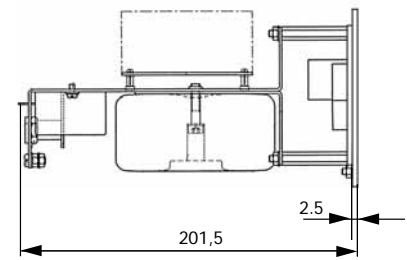

Ecoline-E

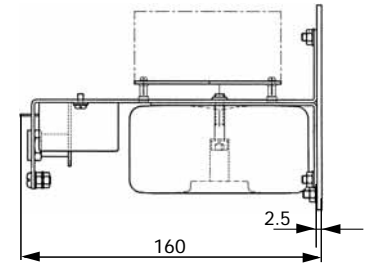

Ecoline-E Remote  
with same front panel but without control panel

Front view (mm)

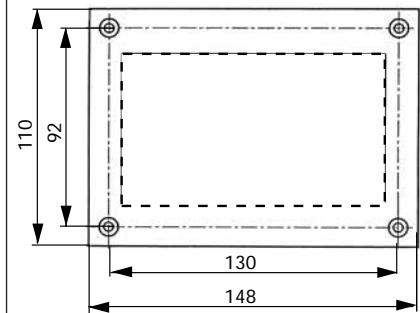

Mounting cut-out (mm)

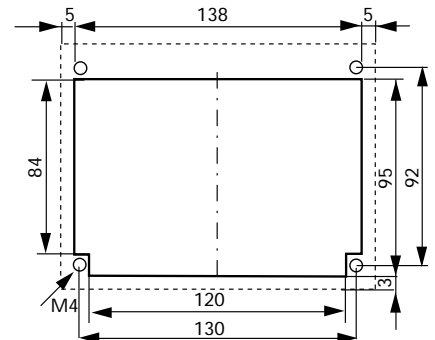

### Technical specifications

Mains connection	230 V / 50/60 Hz or 115 V / 50/60 Hz (please indicate on your order)
Power consumption	max. 110 W
Weight	2.3 kg

### Interfaces

■ Analog input	
Speed control	0-5 V or 0-10 V, 0-20 mA or 4-20 mA
■ Analog output	
Speed output	0-10 V <sub>dc</sub> or 0-12 kHz
■ Digital input (TTL-level)	
Start/Stop, rotation direction	

### Operating panel

- Run/Stop switch
- Switch for rotation direction
- Switch for MAX/SLOW
- 3-digit potentiometer for digital speed setting in 0.1%-steps

### Ordering information

Data sheet	Model	Ecoline-E	Ecoline-E Remote
	Ecoline-E	IS 10354	IS 10353
Included with delivery: data sheet for installation and electrical connections			

08.4  
30.09.05

### IMPORTANT

#### Active cooling system

Adequate ventilation (active cooling) must be provided depending on the installation conditions and the operating time.

The buyer and user himself is responsible for sufficient ventilation of ISMATEC® panel-mounted pumps.